

RECORD OF LAND CORNER MONUMENTATION

CORNER: NE CLOSING COR. SEC. 4, TWP. 9 S., RANGE 27 E., W.M.

ORIGINAL SURVEY BY: Aaron S. York

CONTRACT NUMBER: 335

CONTRACT DATE: August 11, 1879

SUBSEQUENT SURVEYS:

1. W.F. White, County Surveyor, found the original stone in 1893. See Record Map of Survey No. 212.
2. Remonumented in 1971 by Robert D. Bagett, County Surveyor

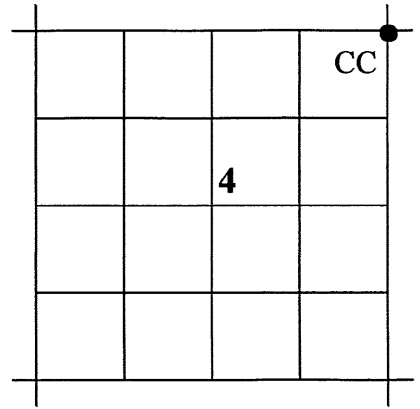

ORIGINAL DESCRIPTION: Set stone 14x12x4 for Closing Cor. to secs. 3 & 4. Stone mound at cor.

WHITE'S RECORD: "I find cor. of secs. 3 and 4 marked 8/27 on South face and CC on south base of stone and three notches on the east edge and 3 on the west..."

BAGETT'S RECORD: "Found 14x12x4 in. basalt stone mkd. 9/27 CC with 3 notches in top of stone and set firmly in a mound of stone, 656.34 ft. E. of Standard Cor. to secs 34 & 35 instead of 86 lks. as called for in the gov't field notes. In 1893 W.F. White found this distance to be 9.94 chs. or 656.04 ft....Set a 1½"x36" iron pipe 15 ins. in the ground, with brass cap mkd. as shown. Raised a mound of stone around pipe to top of cap and placed the original cor. stone N. and alongside pipe. Deposit glass beer bottle at base of pipe. No BTs available."

EVIDENCE FOUND: I found Bagett's brass cap monument in a 2 ft. diameter mound of stone. The cap was protruding 12" from the top of the mound of stone, but the monument was firmly anchored.

DESCRIPTION OF MONUMENTS AND ACCESSORIES SET AND METHODS USED:

I added stones to the mound, increasing the diameter to about 3 feet and raising it to the top of the cap. The Brass cap marked as shown.

From which, I SET THE FOLLOWING REFERENCE POINTS:

- ▶ A 5/8"x30" iron pin bears N.45°07'E., 43.40 ft. with attached green plastic cap marked GCS RP.
- ▶ A 5/8"x30" iron pin bears S.45°05'E., 48.13 ft. with attached green plastic cap marked GCS RP.
- ▶ A 5/8"x30" iron pin bears S.45°02'W., 41.73 ft. with attached green plastic cap marked GCS RP.
- ▶ A 5/8"x30" iron pin bears N.45°00'W., 53.01 ft. with attached green plastic cap marked GCS RP.

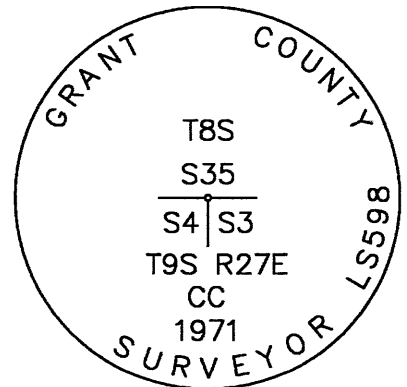

Used RTK GPS to measure the reference points. Bearings are based on Record Map of Survey No. 2031

STATE PLANE COORDINATES (3601 OR N)

Reference Datum: NAD83 from OPUS solution
 Northing: 423,774.6 ft.
 Easting: 8,469,328.1 ft.
 Ellip. Ht: 2,160.2 ft.

RESTORATION BY, STAMP AND DATE:

Work performed May 1, 2015 by:

Jason L. Hatfield, PLS
 Deputy Grant County Surveyor
 217 N. Canyon Blvd.
 John Day, OR 97845

RECEIVED AND FILED
 GRANT COUNTY SURVEYOR

MAY 26 2015

BY:

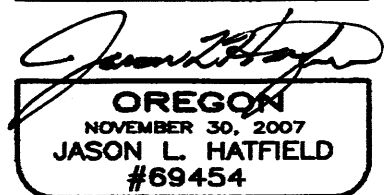

EXPIRES: 6/30/2015